

## INSTALLING INSTRUCTIONS

Pag. 1/2

ALL OPERATIONS MUST BE CARRIED OUT BY QUALIFIED PERSON

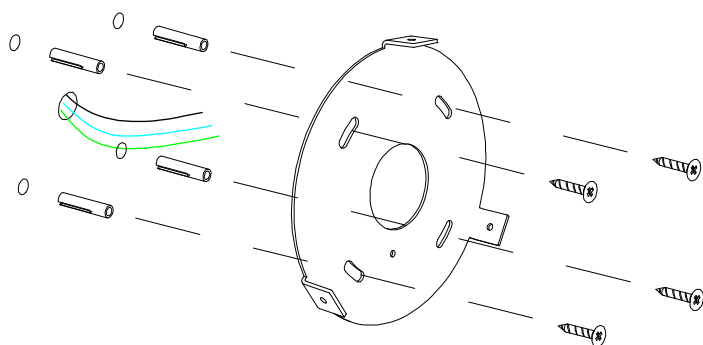

1. Fissare la staffa alla parete (utilizzare un sistema appropriato in relazione al tipo di muro)

1. Fix the bracket to the wall (use appropriate anchors depending on the type of wall)

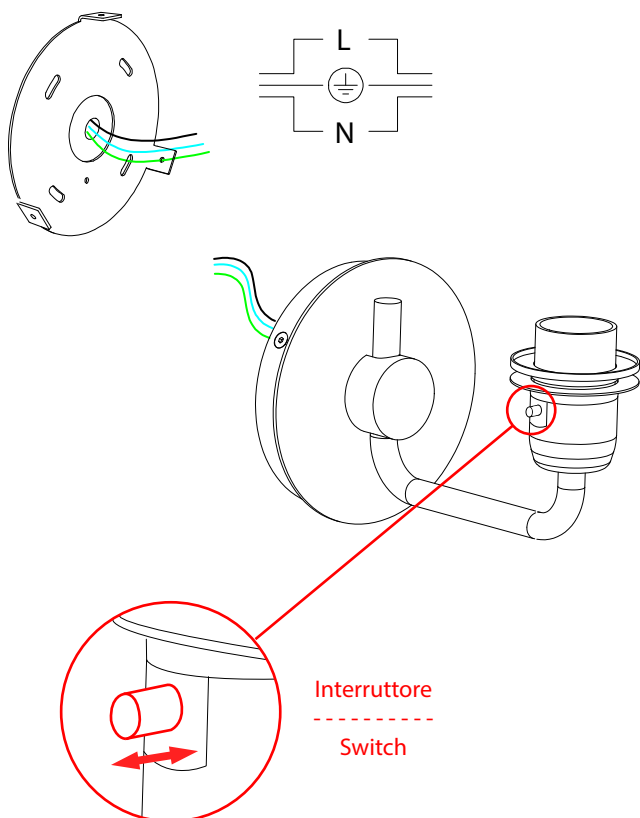

2. Connettere i cavi della corrente seguendo lo schema e fissare la lampada alla staffa usando le viti fornite.

2. Connect the wires following the sketch and fix the lamp to the bracket using the screws provided.

## INSTALLING INSTRUCTIONS

Pag. 2/2

ALL OPERATIONS MUST BE CARRIED OUT BY QUALIFIED PERSON

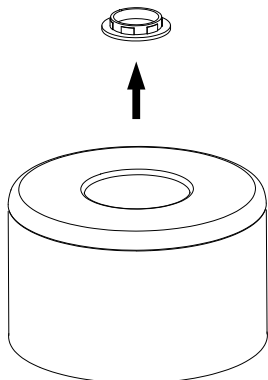

3. Rimuovere esclusivamente la ghiera dal portalampada ed infilare il paralume.

3. Remove only the ring nut from the lamp holder and insert the lampshade.

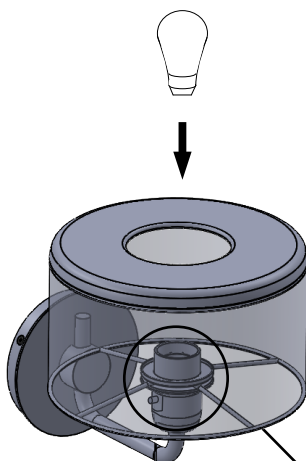
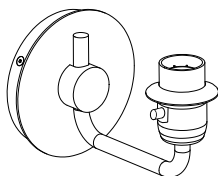

4. Inserire la lampadina, riposizionare la ghiera e stringere per fissare il paralume.

4. Insert the bulb, reposition the ring nut and tighten to fix the lampshade.

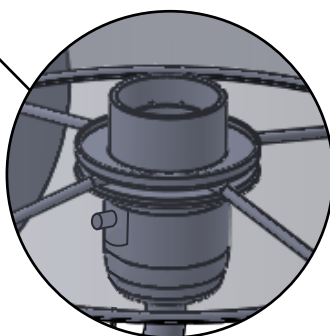

USE A SOFT DAMP CLOTH TO CLEAN ALL LAMP PARTS